

4

3

2

1

REVISION DATA

REV	DESCRIPTION	DATE
A0	NEW DRAWING	2011-04-21

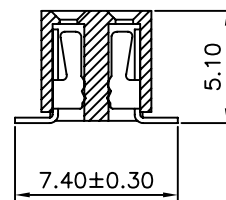
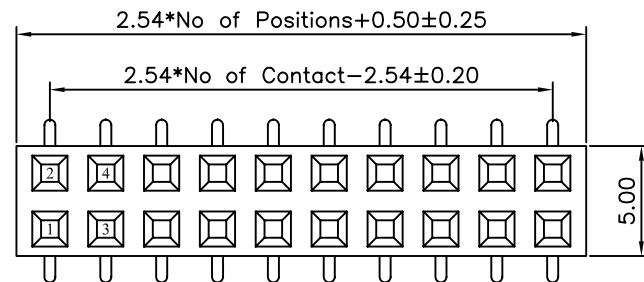

不带柱

5.10±0.20

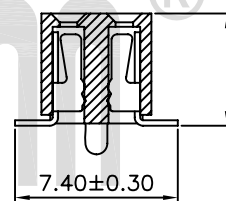
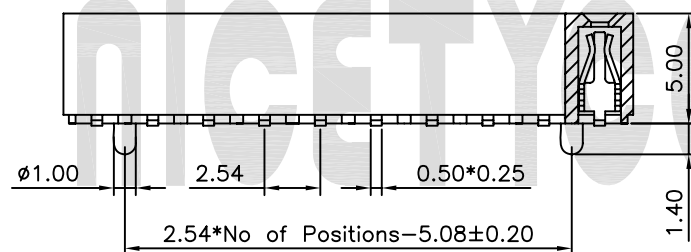

带柱

Technical Data

Material:

Contact Material: Phosphor Bronze

Contact plating: Au or Sn Over 50μ" Ni

Insulator Material: Black Polyester UL94V-0

Standard: PA6T+30%G.F

Electrical:

Current rating: 3.0Amps/contact max.

Contact resistance: ≤20mΩ/contact

Insulation resistance: ≥1000MΩ at V=100V

Withstanding Voltage: 1000V AC/minute

Mechanical:

Mechanical life cycle: min.200

Operating temperature: -40°C to +105°C

Soldering temperature: +255°C

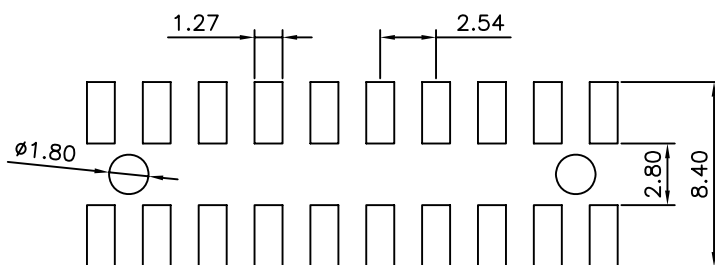

P.C.B LAYOUT

PM	1	50	12	XXX	S	XX	C	X	U	074
品名 PM=排母	间距 1=2.54	塑高 50=5.00mm	产品类型 12=单塑双排	PIN位总数 04~80P	产品折弯类型 S=SMT	表面处理 SN Tin100u* GF Gold Flash G1 Gold 1u" G2 Gold 2u" G3 Gold 3u" G4 Gold 5u" G5 Gold 8u" G6 Gold 10u" G7 Gold 15u" G8 Gold 30u"	塑胶材质 C=PA6T	塑胶特性 N=常规 W=带内柱	塑胶类型 U=U型	端子PC/脚宽

NICETYCOMM®

深圳市创辉诚科技有限公司

SHENZHEN CHUANGHUICHENG TECHNOLOGY CO.,LTD

TOLERANCE	PROJECTON	TITLE:
ANGLE ±5°	DATE : 2011-04-21	双排SMT排母 PH2.54 H5.0 U型 W7.4 PA6T
X.XXX ±0.10	DRAWN :	PART NO: PM15012XXXSXXCXU074
X.XX ±0.20	CHECKED :	DRAWING NO: PM15012SU007
X.X ±0.30	APPROVED :	REV: A0 UNIT: mm SCALE: 3:1 SIZE: A4
X. ±0.50		

4

3

2

1